

REV.	REVISIONS	DATE	APPROVED
A	DESCRIPTION UPDATED TO NEW STANDARD DWG FROM AE-FLKR903	12/11/2012	

**FP-AE-FLKR903
BACKING PLATE FOR AE-FLKR700
0.30 LBS.**

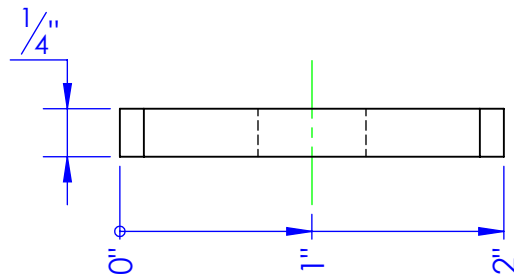
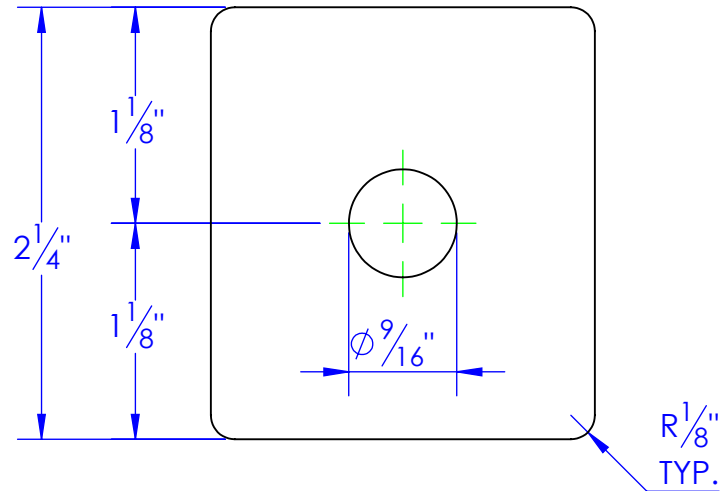

REQD QTY: 4

**FP-AE-FLKR904
BACKING PLATE FOR AE-FLKR700
0.36 LBS.**

REQD QTY: 4

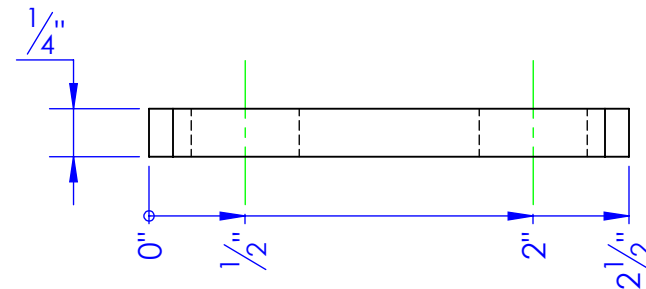
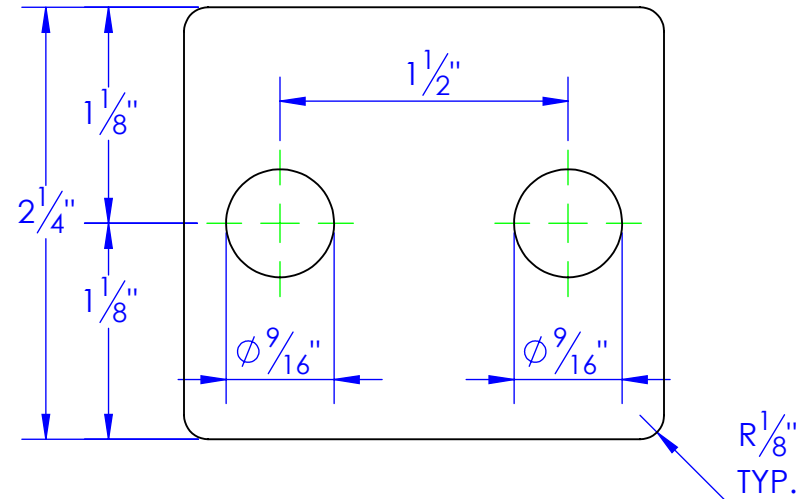

PROPRIETARY AND CONFIDENTIAL
THE INFORMATION CONTAINED IN THIS
DRAWING IS THE SOLE PROPERTY OF TRIPLE
C INC. ANY REPRODUCTION IN PART OR
AS A WHOLE WITHOUT THE WRITTEN
PERMISSION OF TRIPLE C INC. IS PROHIBITED.

DIMENSIONS ARE IN INCHES TOLERANCES: FRACTIONAL $\pm 1/16$ ANGULAR: MACH ± 1 BEND \pm TWO PLACE DECIMAL ± 010 THREE PLACE DECIMAL ± 005		NAME	DATE
DRAWN		HEATH	12/11/2012
PART #		SEE DWG.	
ASM #			
COMMENTS:		TAB FOR FLKR ARM EXTENSIONS	
MATERIAL		--	
DO NOT SCALE DRAWING			

P.O. BOX 248,
SABETHA, KS 66534

TRIPLE C
INC.

SIZE A	DWG. NO. 40-2509	REV. A
SCALE: 1:1	WEIGHT: --	SHEET 1 OF 1